



FLEX-TITE INSULATION CLIP

Victory Bear's Flex-Tite insulation clips are a two-piece system for quickly and easily sealing and finishing the seams in rigid foam insulation. Attractive and functional, Flex-Tite clips are designed to save installation labor and energy costs.

FEATURES & BENEFITS

Energy Efficient Design

Our Flex-Tite technology seals tightly against the insulation board to reduce thermal loss at the seams.

Long Lasting

Flex-Tite clips are an attractive and durable option for sealing and finishing seams in insulation board. Once installed, they will likely never need replacing.

Convenient Fastening

The Flex-Tite Female piece features a convenient fastening leg for easy access with a nail gun, reducing installation time. The matching Male piece then snaps in for a tight fit.



FLEX-TITE INSTALLATION



INSTALLATION

Step 1 - Align the Flex-Tite J-Channel horizontally at the desired height and check for level. Nail or staple into place.

Step 2 - Align the Flex-Tite Female clip vertically at desired spacing and check for plumb. Use a 3/4" to 1" nail to affix to the concrete wall.

Step 3 - Install the insulation board per the manufacturer's instructions. Clip the Flex-Tite Male into the Female, then repeat Steps 1-3.

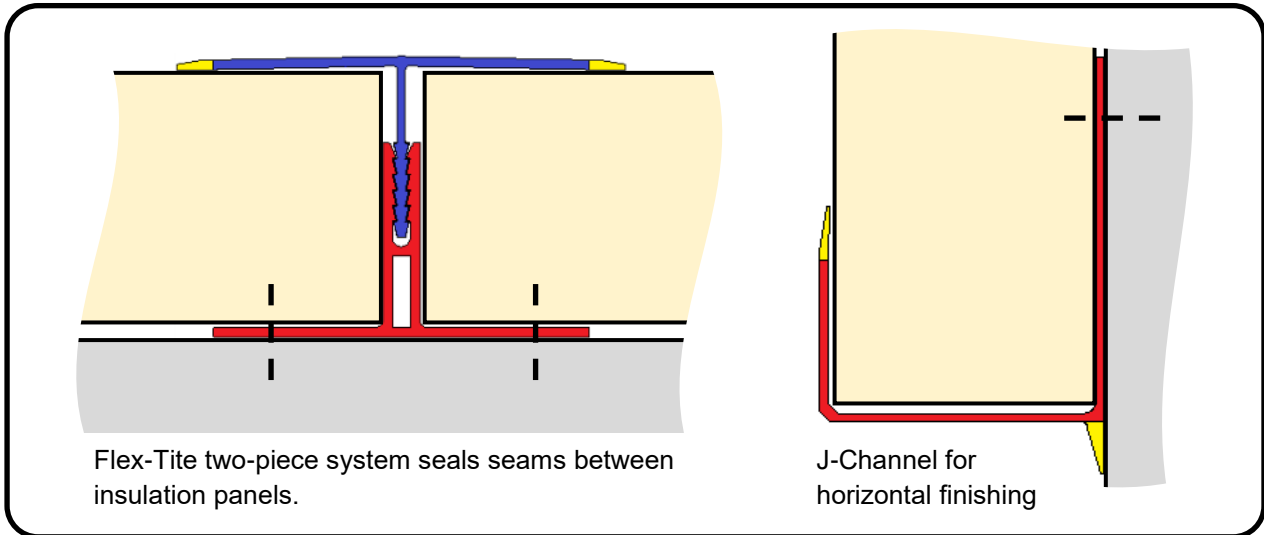

FLEX-TITE DIMENSIONS AND PAIRINGS



VICTORY BEAR J-CHANNEL

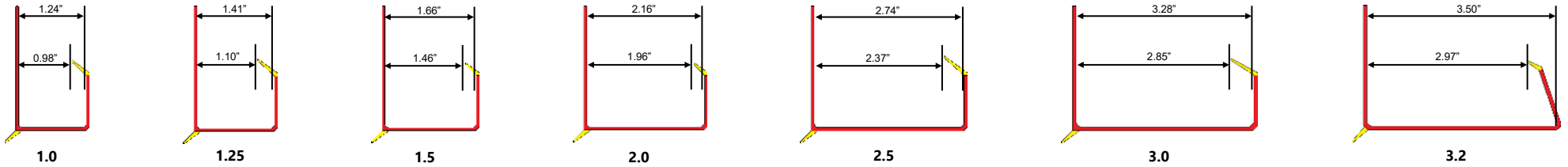

VICTORY BEAR FLEX-TITE

FEMALE CLIP (FTF)

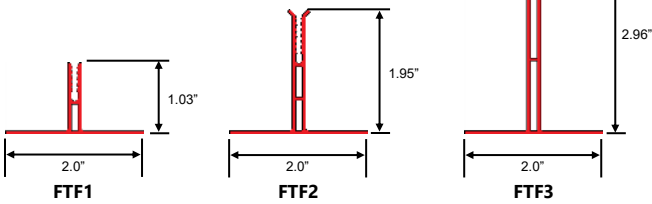

MALE CLIP (FTM)

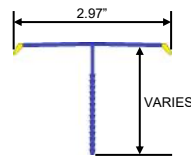

FLEX-TITE SIZE CHART

| Board Thickness | Flex-Tite Female | Flex-Tite Male | J-Channel |
|-----------------|------------------|----------------|-----------|
| 1" | FTF1 | FTM03 | 1540 |
| 1.25" | FTF1 | FTM03 | 751 |
| 1.5" | FTF1 | FTM06 | 769 |
| 1.75" | FTF1 | FTM09 | 1158 |
| 2" | FTF2 | FTM05 | 1541 |
| 2.25" | FTF2 | FTM09 | 1541 |
| 2.5" | FTF2 | FTM10 | 1153 |
| 2.75" | FTF2 | FTM13 | 1547* |
| 3.0" | FTF3 | FTM05 | 1547 |
| 3.2" | FTF3 | FTM06 | 1560 |
| 3.5" | FTF3 | FTM10 | N/A |
| 4.0" | FTF3 | FTM14* | N/A |

*Special order

| Part Number | Style Number | Part Name | Pieces Per Box | Ft. Per Box |
|-------------|--------------|----------------------|----------------|-------------|
| 748 | FTF1 | Flex-Tite Female 1 | 20 | 200 |
| 970 | FTF2 | Flex-Tite Female 2 | 20 | 200 |
| 1548 | FTF3 | Flex-Tite Female 3 | 20 | 200 |
| 786 | FTM03 | Flex-Tite Male 03 | 20 | 200 |
| 764 | FTM05 | Flex-Tite Male 05 | 20 | 200 |
| 749 | FTM06 | Flex-Tite Male 06 | 20 | 200 |
| 762 | FTM09 | Flex-Tite Male 09 | 20 | 200 |
| 771 | FTM10 | Flex-Tite Male 10 | 20 | 200 |
| 772 | FTM13 | Flex-Tite Male 13 | 20 | 200 |
| 1540 | 1540 | J-Channel 1.0" | 20 | 200 |
| 751 | 751 | J-Channel 1.25" | 20 | 200 |
| 769 | 769 | J-Channel 1.5" | 20 | 200 |
| 1158 | 1158 | J-Channel 1.75" | 20 | 200 |
| 1541 | 1541 | J-Channel 2.0" | 20 | 200 |
| 1153 | 1153 | J-Channel 2.5" | 20 | 200 |
| 1547 | 1547 | J-Channel 2.75"-3.0" | 20 | 200 |
| 1560 | 1560 | J-Channel 3.2" | 20 | 200 |



J-CHANNEL

Victory Bear J-Channels provide a clean and attractive finish for polyiso and fiberglass insulation. They are designed for ease of installation, durability, and energy efficiency.

The J-Channel matches Victory Bear's Flex-Tite and Quick Clip products in appearance and properties, making it the perfect option for a complete insulation retaining system.

FEATURES & BENEFITS

Energy Efficient Design

Victory Bear J-Channel's flexible fins create an air seal against both the polyiso board and the substrate wall, preventing thermal loss.

Impact Resistant

The J-Channel can be cut with power saws, and can withstand the impact of nail guns, making installation easy.

Attractive Bright White Finish

Victory Bear J-Channel is manufactured with an attractive white finish that does not require painting.

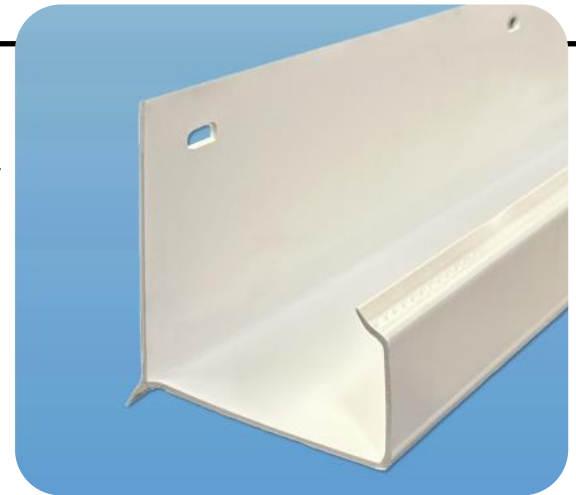

J-CHANNEL INSTALLATION



INSTALLATION

Step 1 - Align the J-Channel horizontally at the desired height and check for level. Use a 3/4" to 1" nail to affix to the concrete wall through the nail fin. Attach at openings and other areas where insulation edges would be exposed as well.

Step 2 - If using, attach the Victory Bear Quick Clip or Flex-Tite to the substrate wall per the product instructions.

Step 3 - Insert the insulation board into the J-Channel and attach to the wall per the manufacturer's instructions. Board should be tucked under the J-Channel's flexible fin.

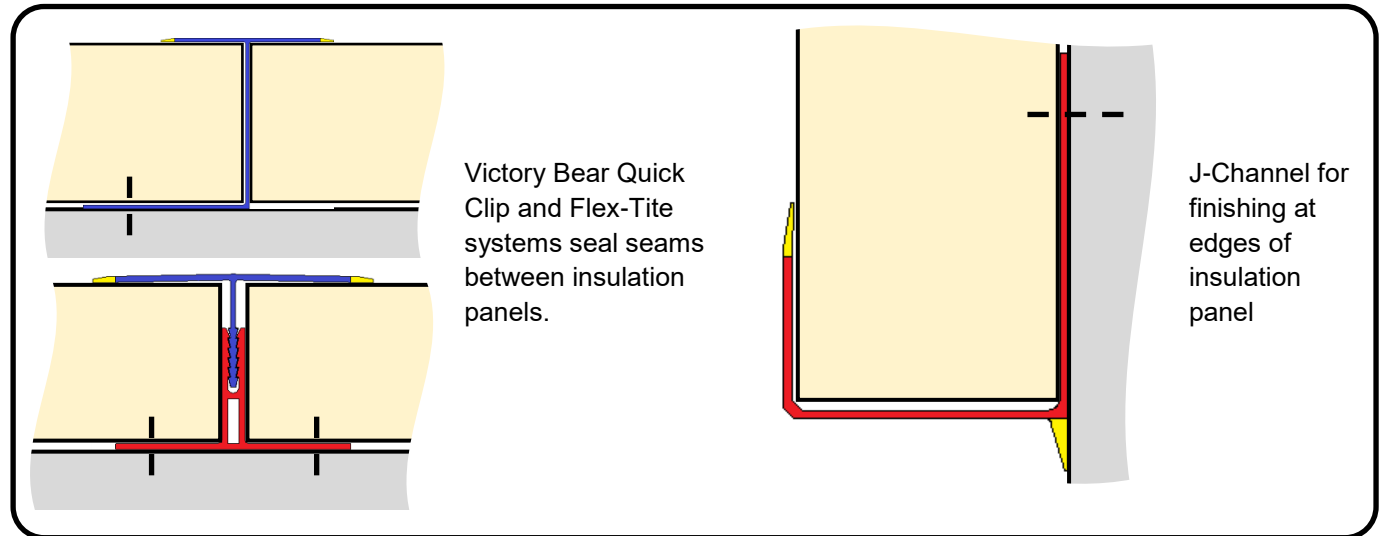

SEE THE VICTORY BEAR DIFFERENCE

Foil Tape vs. Victory Bear

The image on the left illustrates how the use of tape to finish the edges and seams of polyiso board can lead to unattractive and undesirable results.

On the left, Victory Bear J-Channel and Flex-Tite were used to create a durable and attractive finish.



STANDARD FOIL TAPE



VICTORY BEAR
J-CHANNEL AND FLEX-TITE

J-CHANNEL DIMENSIONS



VICTORY BEAR J-CHANNEL

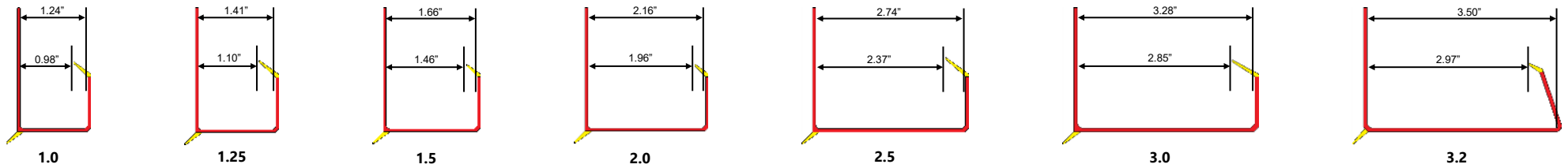

VICTORY BEAR J-CHANNEL PRODUCT INFORMATION

| Part Number | Part Name | Pieces Per Box | Ft. Per Box |
|-------------|-----------------|----------------|-------------|
| 1540 | J-Channel 1.0" | 20 | 200 |
| 751 | J-Channel 1.25" | 20 | 200 |
| 769 | J-Channel 1.5" | 20 | 200 |
| 1158 | J-Channel 1.75" | 20 | 200 |
| 1541 | J-Channel 2.0" | 20 | 200 |
| 1153 | J-Channel 2.5" | 20 | 200 |
| 1547 | J-Channel 3.0" | 20 | 200 |
| 1560 | J-Channel 3.2" | 20 | 200 |





QUICK CLIP

The Victory Bear Quick Clip insulation retaining system is ideal for sealing the seams between rigid insulation boards. Its quick and easy installation method—Quick Clip can withstand the impact of a nail gun—helps reduce your overall costs. Its attractive finish also provides a superior look for your insulated walls.

FEATURES & BENEFITS

Energy Efficient Design

Quick Clips are coextruded from rigid and soft PVC to form an air-tight seal against the insulation board.

Long Lasting

Quick Clips are an attractive and durable option for sealing and finishing seams in insulation board. Once installed, they will likely never need replacing.

UL Tested

Class A material, tested by Underwriters Laboratories (UL 723—test for surface burning characteristics of building materials). Flame spread is 0 and smoke developed equals 190.



QUICK CLIP INSTALLATION



INSTALLATION

Step 1 - Align the Victory Bear J-Channel horizontally at the desired height and check for level. Nail or staple into place.

Step 2 - Align the Quick Clip vertically at desired spacing and check for plumb. Use a 3/4" to 1" nail to affix to the concrete wall through the nail fin.

Step 3 - Install the insulation board per the manufacturer's instructions. Board should be tucked under the Quick Clip "T" section for a tight seal.

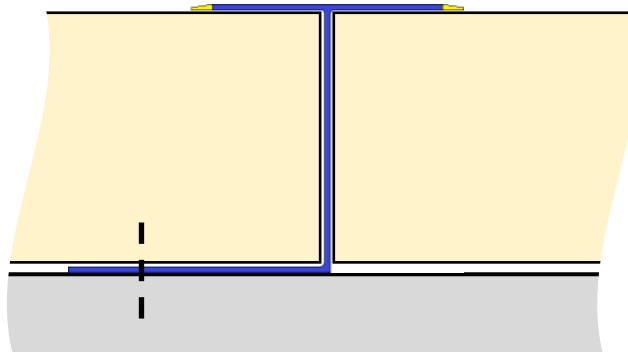

Quick Clip seals seams between insulation panels.

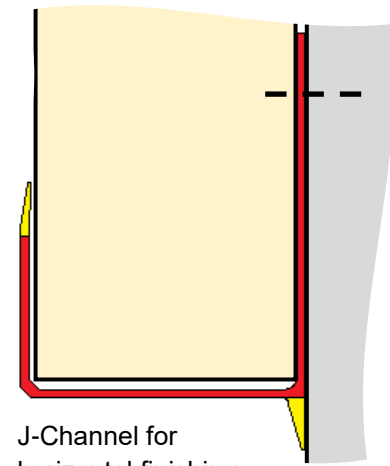

J-Channel for horizontal finishing



QUICK CLIP DIMENSIONS



VICTORY BEAR J-CHANNEL

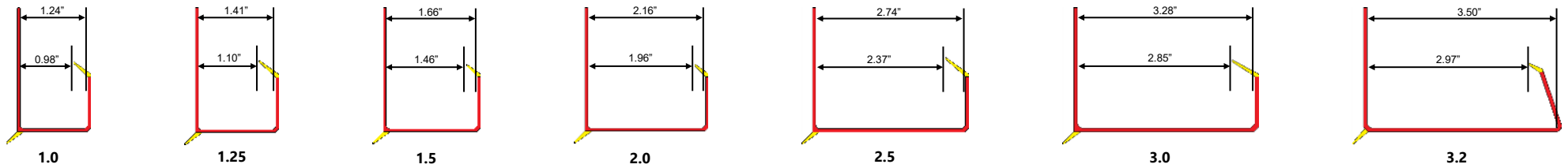

VICTORY BEAR QUICK CLIP

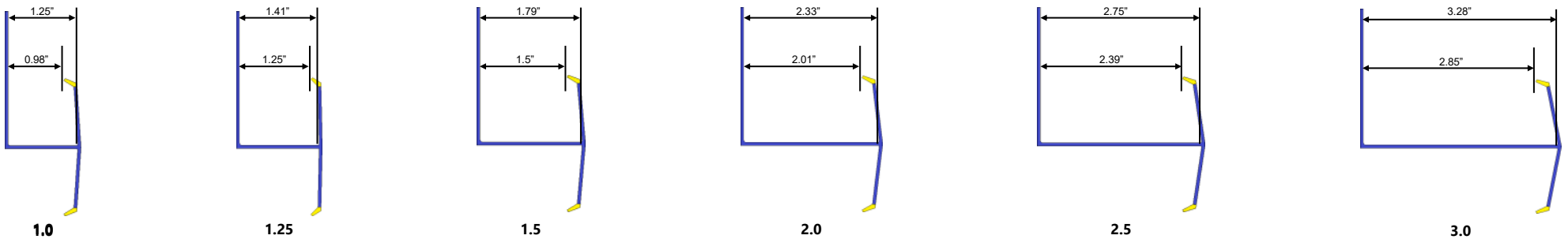

VICTORY BEAR J-CHANNEL PRODUCT INFORMATION

| Part Number | Part Name | Pieces Per Box | Ft. Per Box |
|-------------|----------------------|----------------|-------------|
| 1540 | J-Channel 1.0" | 20 | 200 |
| 751 | J-Channel 1.25" | 20 | 200 |
| 769 | J-Channel 1.5" | 20 | 200 |
| 1158 | J-Channel 1.75" | 20 | 200 |
| 1541 | J-Channel 2.0" | 20 | 200 |
| 1153 | J-Channel 2.5" | 20 | 200 |
| 1547 | J-Channel 2.75"-3.0" | 20 | 200 |
| 1560 | J-Channel 3.2" | 20 | 200 |

VICTORY BEAR QUICK CLIP PRODUCT INFORMATION

| Part Number | Part Name | Pieces Per Box | Ft. Per Box |
|-------------|------------------|----------------|-------------|
| 1552 | Quick Clip 1.0" | 20 | 200 |
| 861 | Quick Clip 1.25" | 20 | 200 |
| 1551 | Quick Clip 1.5" | 20 | 200 |
| 1553 | Quick Clip 2.0" | 20 | 200 |
| 1555 | Quick Clip 2.5" | 20 | 200 |
| 1554 | Quick Clip 3.0" | 20 | 200 |