

For Concrete Construction

## FLEX-TITE INSULATION CLIPS

Victory Bear Flex-Tite insulation clips are quick, easy, and efficient to work with. They provide a finishing touch that is attractive as well as functional. They are designed to save labor in installation, and save energy once finished.

### Features & Benefits

- **Energy Efficient Design** – Our Flex-Tite system seals tightly against the insulation board to **reduce thermal loss** at the seams.
- **Easy Installation** – Flex-Tite clips' two-piece design allows for **easy installation**.
- **Convenient Fastening Area** – All Flex-Tite and Quick Clip systems have a convenient fastening leg for easy access with a nail gun, reducing installation time.
- **Reduce costs with Impact-Resistant PVC** – Our Flex Tite systems are designed to withstand the high impact of nail guns and power saws, **saving you labor costs**.
- **Attractive Finish** – Our Flex-Tite systems are manufactured to an **attractive** white finish and do not require painting. Call for custom color applications.
- **UL Tested** – Class A material, tested by Underwriters Laboratories (UL 723 – test for surface burning characteristics of building materials). Flame spread is 0 and smoke developed equals 190.



Flex-Tite wall installation

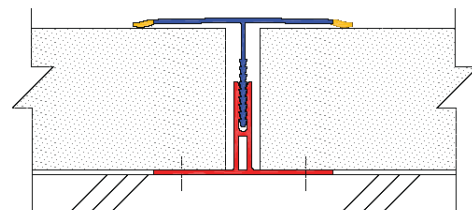
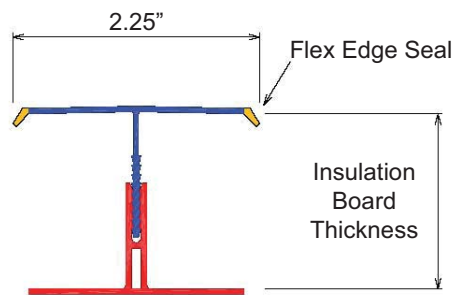

Two-piece Flex-Tite system

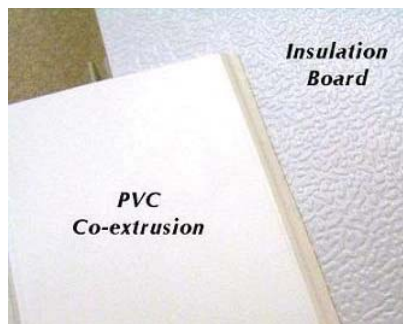

**Fukuvi USA, Inc.**  
**Victory Bear Products**  
 7631 Progress Court  
 CenterPoint 70 Commerce Park  
 Huber Heights, OH 45424

[www.fukuvi-usa.com](http://www.fukuvi-usa.com)  
[www.victorybear.com](http://www.victorybear.com)



**MADE IN USA**

**Customer Support**  
 (937) 236-7288 ext. 247/231  
[aheskett@fukuvi-usa.com](mailto:aheskett@fukuvi-usa.com)  
[jdresel@fukuvi-usa.com](mailto:jdresel@fukuvi-usa.com)  
 Fax: (937) 236-7289

For Concrete Construction

## FLEX-TITE INSULATION CLIPS

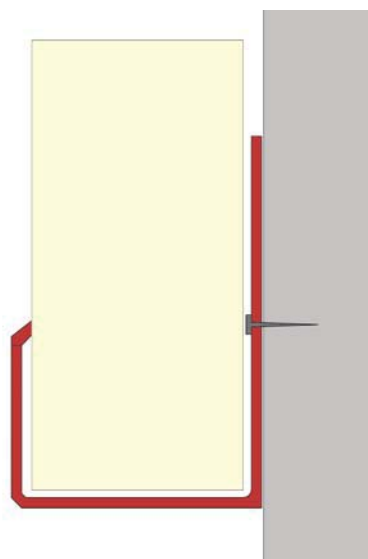

J-Channel

### Installation

- **Step 1** – Align the Flex-Tite J-Channel horizontally at the desired height and check for level. Nail or staple into place.
- **Step 2** – Align the Flex-Tite female clip vertically at desired spacing and check for plumb. Nail or staple into place.
- **Step 3** – Install insulation and Flex-Tite male, then repeat.

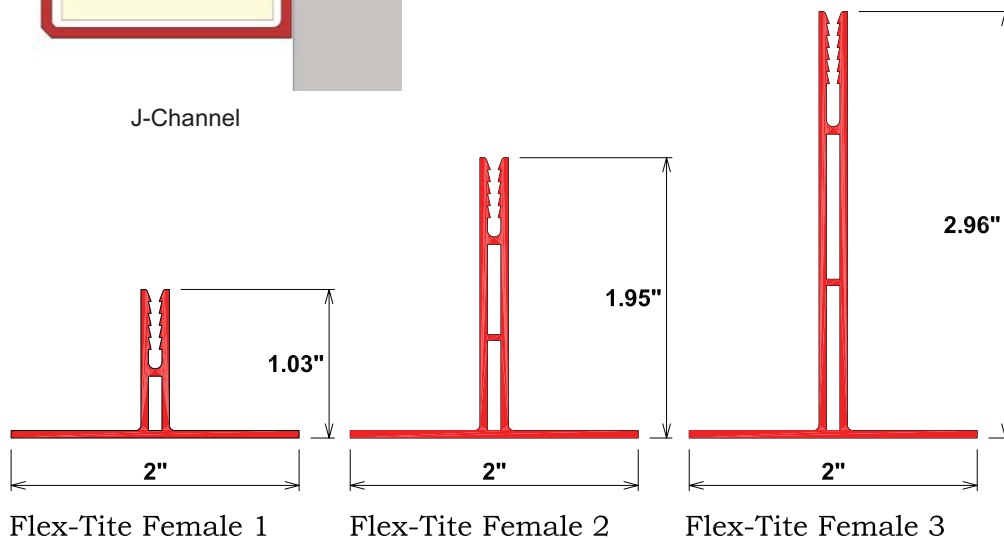

| Flex-Tite & Insulation Board Sizing Chart |                             |                               |
|---|-----------------------------|-------------------------------|
| Insulation Board Thickness                | Corresponding Fukuvi Male # | Corresponding Fukuvi Female # |
| 1.0"                                      | FTM03                       | FTF1                          |
| 1.25"                                     | FTM06                       | FTF1                          |
| 1.5                                       | FTM09                       | FTF1                          |
| 1.55"                                     | FTM10                       | FTF1                          |
| 1.75"                                     | FTM12                       | FTF1                          |
| 2.0"                                      | FTM05                       | FTF2                          |
| 2.25"                                     | FTM06                       | FTF2                          |
| 2.5"                                      | FTM10                       | FTF2                          |
| 2.75"                                     | FTM13                       | FTF2                          |
| 3.0"                                      | FTM05                       | FTF3                          |
| 3.25"                                     | FTM06                       | FTF3                          |
| 3.5"                                      | FTM10                       | FTF3                          |
| 3.75"                                     | FTM13                       | FTF3                          |

All Flex-Tite Insulation Retainers are 10 ft./piece, 20 pieces/box.

**Fukuvi USA, Inc.**  
**Victory Bear Products**  
 7631 Progress Court  
 CenterPoint 70 Commerce Park  
 Huber Heights, OH 45424

www.fukuvi-usa.com  
 www.victorybear.com



**MADE IN USA**

**Customer Support**  
 (937) 236-7288 ext. 247/231  
 aheskett@fukuvi-usa.com  
 jdresel@fukuvi-usa.com  
 Fax: (937) 236-7289