

For Tilt-up
Construction

F - 26™ CONSTRUCTION ADHESIVE

Victory Bear is proud to provide F-26™, the premium grade, heavy-duty construction adhesive from Leech®.

F-26 can be used with Victory Bear chamfers and rustications for the perfect glue-down system! F-26's amazing bond and easy clean-up save the time and expense of patching holes left in your slab by fasteners. Its strength and versatility in any climate make it the perfect choice for gluing down Victory Bear Rustications and Chamfers!

Features & Benefits

- **Save Money!** – F-26 reduces labor and material costs. It applies more easily and dries more quickly in any climate, while requiring less material for the job, and producing a stronger bond than any other construction adhesive of its kind on the market.
- **All Temperature, All Season Application** – Get the job done despite extreme weather conditions. F-26 won't ever get runny or stiff, so it's easy to use in any weather.
- **Waterproof** – Use F-26 anywhere that moisture is present without affecting the quality of the cured bond!
- **Easy Clean-up** – Dried adhesive can be scraped up after the tilt, leaving your slab clean and free of blemishes!

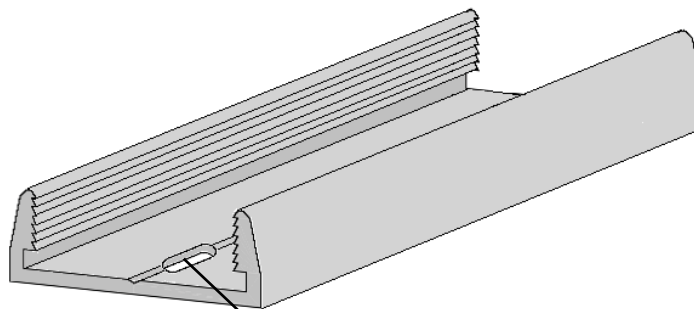

Victory Bear Base Clips and chamfers are punched at regular intervals, creating a rivet-like effect with F-26 to ensure a strong bond to the slab.

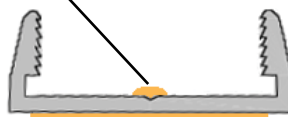

Fukuvi USA, Inc.
Victory Bear Products
7631 Progress Court
CenterPoint 70 Commerce Park
Huber Heights, OH 45424

www.fukuvi-usa.com
www.victorybear.com

Customer Support
Jon Dresel
(937) 236-7288 ext. 231
jdresel@fukuvi-usa.com
Fax: (937) 236-7289

For Tilt-up
Construction

F - 26™ CONSTRUCTION ADHESIVE

Product Specifications:

Volume per tube:	29 fl. oz.
Tubes per box:	12
Weight per box:	28 lbs.
Service temperature:	-20° F to 140° F (-29° C to 60° C)
Open (working) time:	Approximately 30 minutes (Affected by temperature, humidity, and air circulation)
Mastic type:	Synthetic elastomeric polymer and resins
Freeze/thaw stability:	Unaffected by freezing
Viscosity:	Approximately 150,000 CPS - (medium mastic)
Storage stability:	Over 12 months in tightly sealed containers
Application:	Gun extrusion
Solvent limitations:	Keep product away from any polystyrene plastic or lacquer surfaces since it contains solvents that could damage them.
Coverage:	Approximately 150-200 lineal ft. per tube
Clean up:	Material can be scraped off of the slab after the walls are lifted and the forms removed. Material should be cleaned from the slab as soon as possible. Dried adhesive should not be left exposed to the elements for long periods of time to avoid leaving a permanent residue.

Note: F-26 has been thoroughly tested and found to be the most effective adhesive used with Victory Bear Base Clips, rustications and chamfers, and used in practice with great success. As with any glue, however, jobsite conditions can create variables which may cause the adhesive to fail in some instances. Fukuvi USA, Inc./Victory Bear Products assumes no responsibility in instances where F-26 does not adhere as desired.



Fukuvi USA, Inc.
Victory Bear Products
 7631 Progress Court
 CenterPoint 70 Commerce Park
 Huber Heights, OH 45424

www.fukuvi-usa.com
www.victorybear.com

Customer Support
 Jon Dresel
 (937) 236-7288 ext. 231
jdresel@fukuvi-usa.com
 Fax: (937) 236-7289